

Restaurant Spaces in Carmel Mountain Plaza

FOR LEASE

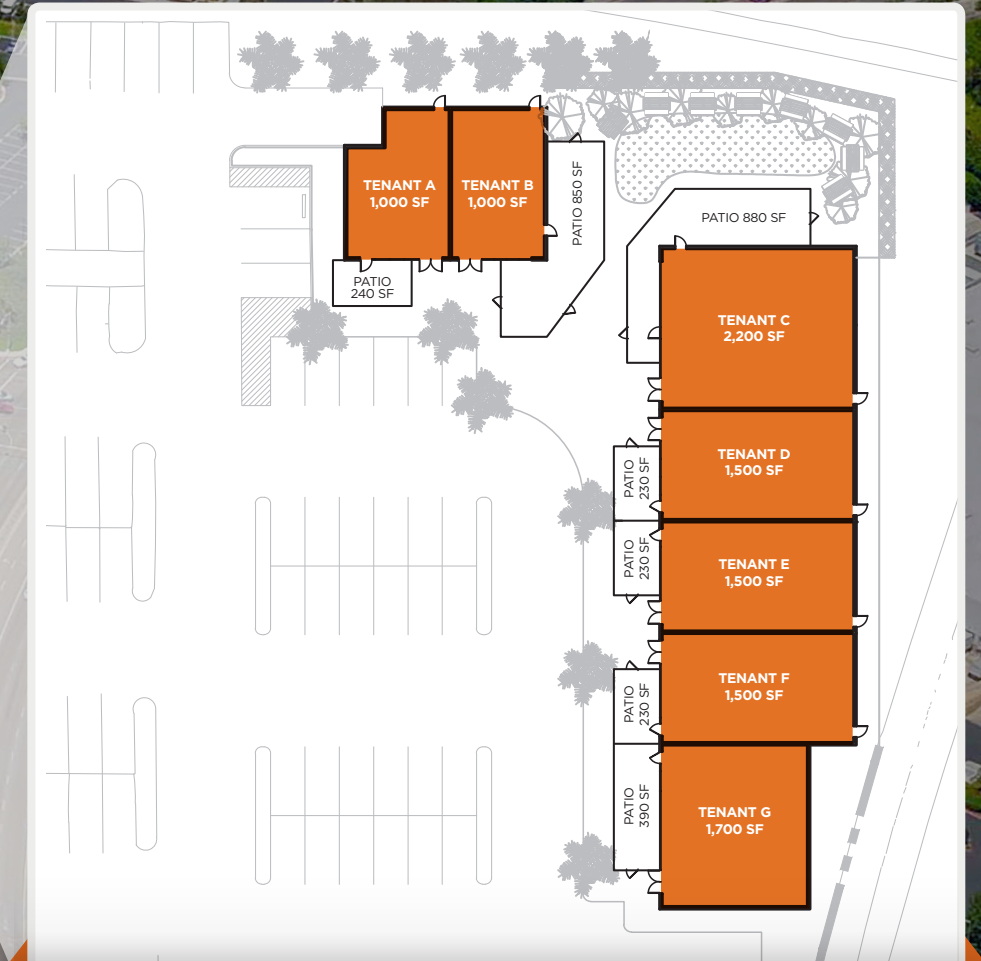

SITE

12384 Carmel Mountain Rd., San Diego, CA 92128 / 1,000 SF - 2,200 SF

PRIME

Carmel Mountain Ranch Location

- ◆ Phenomenal opportunity to get into brand new restaurant space in Carmel Mountain Ranch's most active shopping center
- ◆ Highly desirable corner location on a busy intersection
- ◆ Easily accessible, right off the I-15 Freeway, with an expansive parking lot
- ◆ Incredible signage visibility from Carmel Mountain Rd. with over 29,000 cars driving by daily
- ◆ Extremely strong restaurant trade area with high sales from neighboring restaurants
- ◆ In a bustling shopping center, surrounded by national retail tenants and Costco bringing in a large regional draw
- ◆ Heavy daytime traffic, with an abundance of Class A office space nearby
- ◆ Dense neighborhood location, with over 228,000 residents in a 5-mile radius & incomes in excess of \$146,000

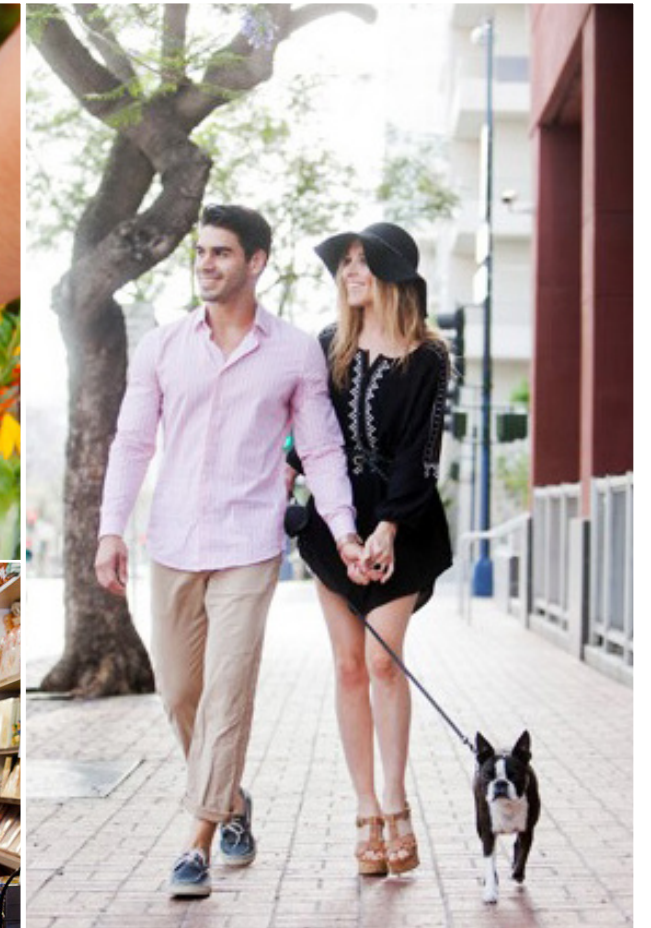

Renowned Neighbors



Site Plan



12384 Carmel Mountain Rd., San Diego, CA 92128



Floor Plan



12384 Carmel Mountain Rd., San Diego, CA 92128

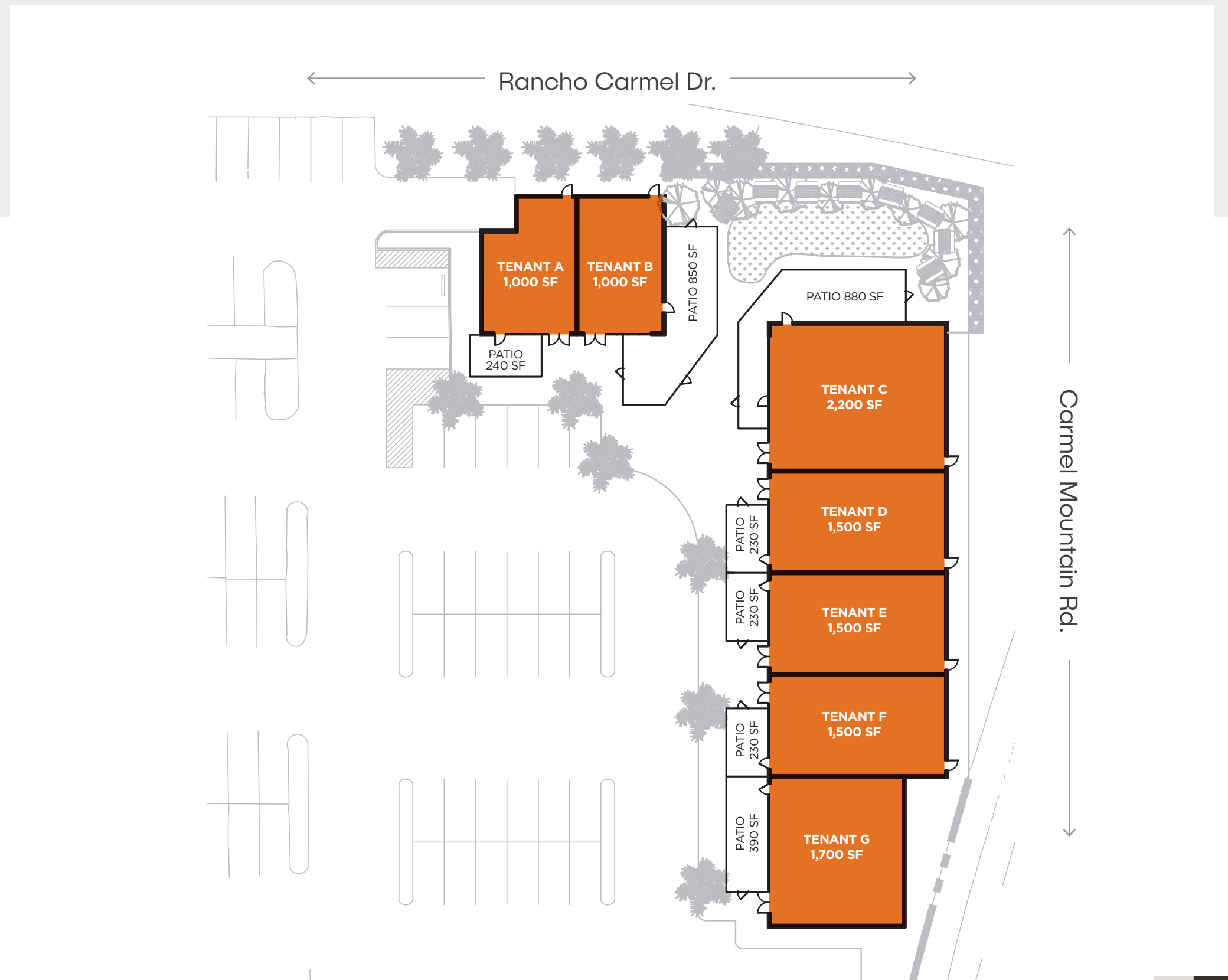

01
Sesame Donuts



03
The Baked Bear
Custom Ice Cream Sandwiches



05
NORDSTROM
rack



07
MARTIN'S JALAPEÑOS
Established Since 1995
AUTHENTIC MEXICAN FOOD AND SEAFOOD



09
Ralphs



12
FISH DISTRICT
- EATERY -

13
the Habit
BURGER GRILL

14
grub
BURGER BAR

15
ISLANDS
fine burgers & drinks

16
COSTCO
WHOLESALE

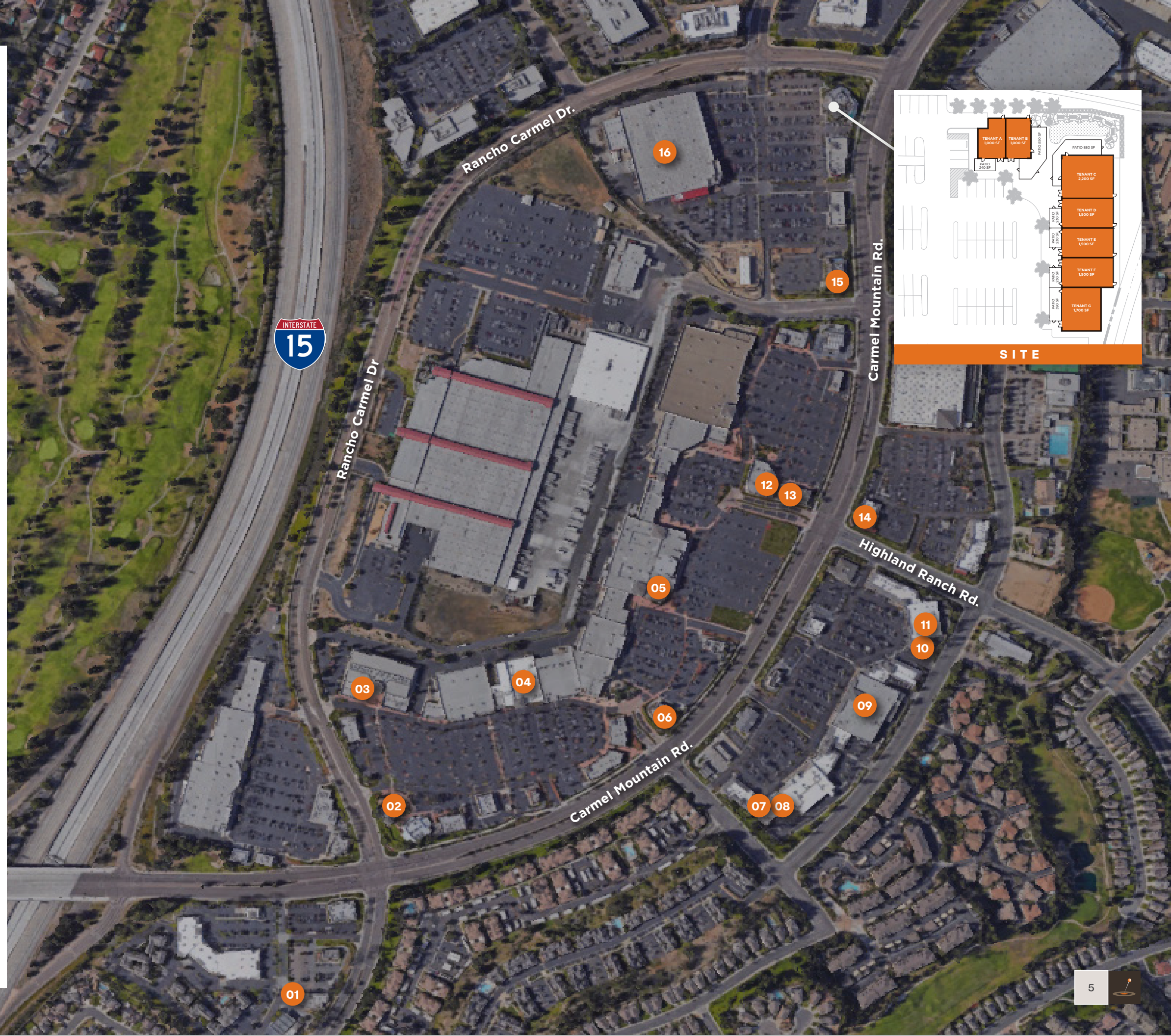

Demographics

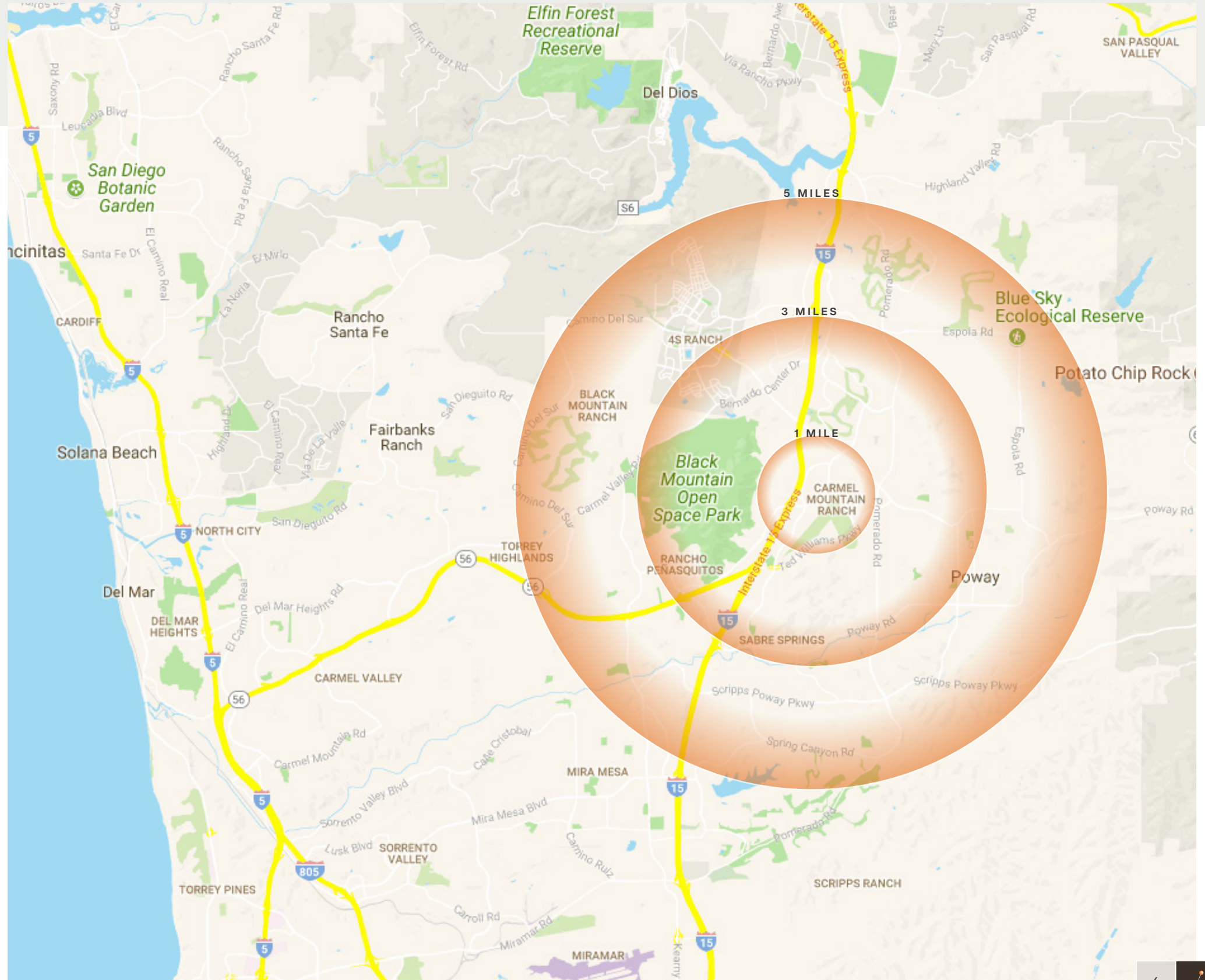

1 MILE

Daytime Population	9,353
Population	15,278
Average HH Income	\$123,111

3 MILES

Daytime Population	44,682
Population	98,771
Average HH Income	\$129,978

5 MILES

Daytime Population	77,189
Population	228,406
Average HH Income	\$146,707



FOR LEASE

12384 Carmel Mountain Rd., San Diego, CA 92128

Leasing Inquiries



Michael Spilky, President

CA LIC #01469032

858-792-5521

mike@locationmatters.com



Alexis Dachs, Client Services

CA LIC #02040500

858-427-2593

alexis@locationmatters.com

locationmatters.com

