

FOR SALE



Two Adjacent Fixturized Sky Deck Restaurants

567 SF

PRICE:	\$295,000
LOCATION:	12841 El Camino Real, Ste 206
REASON FOR SELLING:	Other Ventures
DEAL STRUCTURE:	Cash
SIZE:	567 SF
RENT:	\$7.50/SF + NNN
LEASE TERM:	7 Years + One 5 Year Option
ABC LICENSE:	Type 41
PARKING:	Expansive Parking Lot



Mike Spilky

858-764-4223
mike@locationmatters.com
CA LIC #01469032

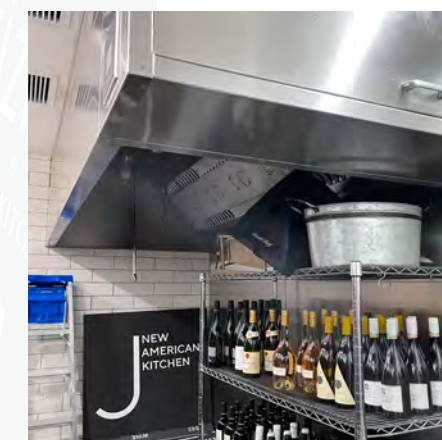



Currently
Ziziki's
Street Food



Prime Sky Deck Location
in Del Mar Highlands
Town Center



*Please do not disturb employees

- Incredible opportunity to purchase a fast casual restaurant in Carmel Valley's newest dining destination, Sky Deck
- Newly built restaurant with contemporary finishes and fully fixturized kitchen with an 8 foot hood and grease interceptor
- Become a part of this one-of-a-kind restaurant collective that offers one of the most unique dining experiences in all of San Diego County
- Type 41 license available to transfer
- Join local favorites and first-to-market brands like Urbana Gastronomy, Ambrogio 15, Craft House, Glass Box, Kiin Extraordinary Thai, Le Parfait Paris, Marufuku Ramen, & Understory, in addition to Booch Craft, Northern Pine, and Rough Draft on the Brewer's Deck



FOR SALE

Two Adjacent Fixturized Sky Deck Restaurants

1,697 SF

PRICE:	\$395,000
LOCATION:	12841 El Camino Real, Ste 206
REASON FOR SELLING:	Other Ventures
DEAL STRUCTURE:	Cash
SIZE:	1,697 SF
RENT:	\$6.63/SF + NNN
LEASE TERM:	7 Years + One 5 Year Option
ABC LICENSE:	Type 41
PARKING:	Expansive Parking Lot



Mike Spilky

858-764-4223
mike@locationmatters.com
CA LIC #01469032

LOCATION
MATTERS

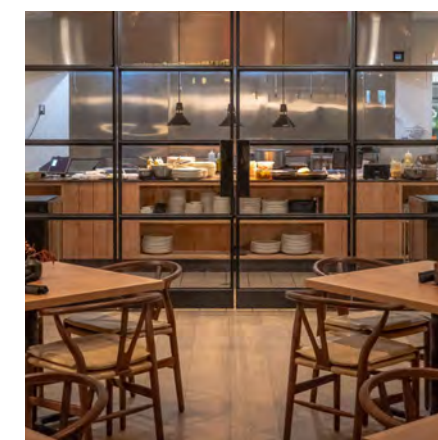
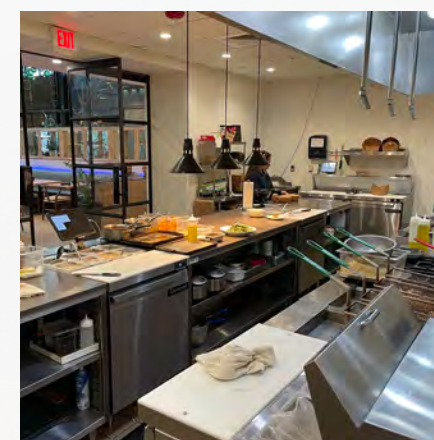



Currently
Ziziki's



*Please do not disturb employees



Prime Sky Deck Location in
Del Mar Highlands
Town Center

- Incredible opportunity to purchase a full service restaurant in Carmel Valley's newest dining destination, Sky Deck
- Newly built restaurant with contemporary finishes and fully fixturized kitchen with a 12 foot hood and grease interceptor

- Become a part of this one-of-a-kind restaurant collective that offers one of the most unique dining experiences in all of San Diego County
- Type 41 license available to transfer

- Join local favorites and first-to-market brands like Urbana Gastronomy, Ambrogio 15, Craft House, Glass Box, Kiin Extraordinary Thai, Le Parfait Paris, Marufuku Ramen, & Understory, in addition to Booch Craft, Northern Pine, and Rough Draft on the Brewer's Deck



SKY DECK TENANTS

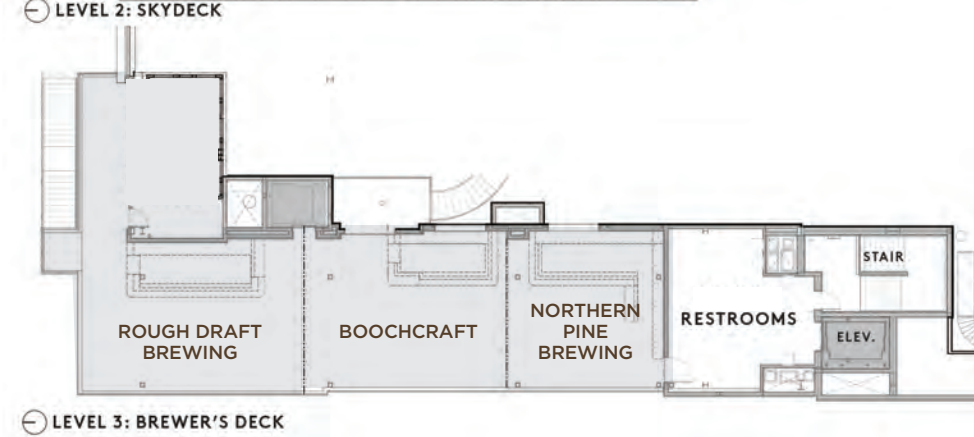
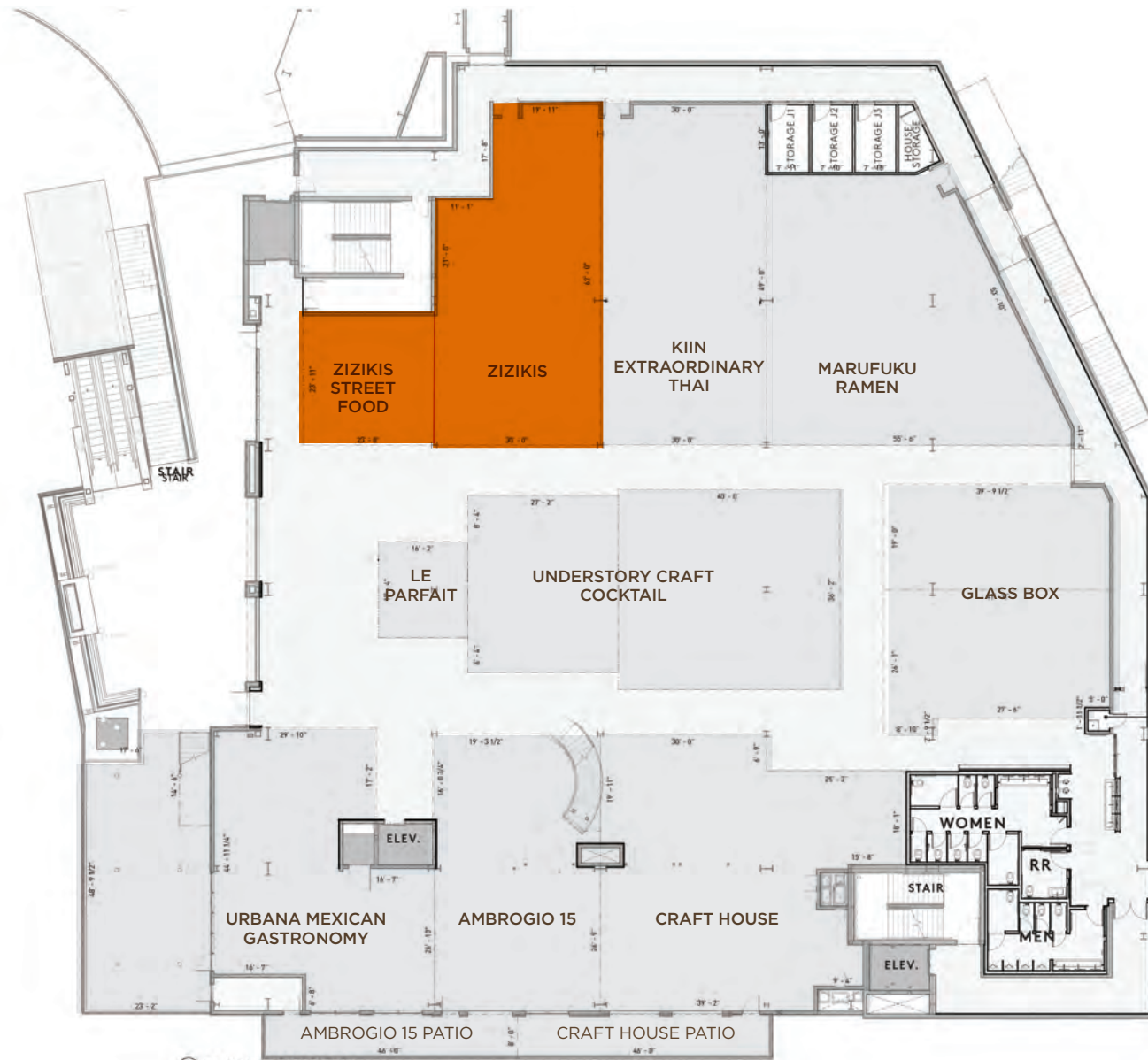
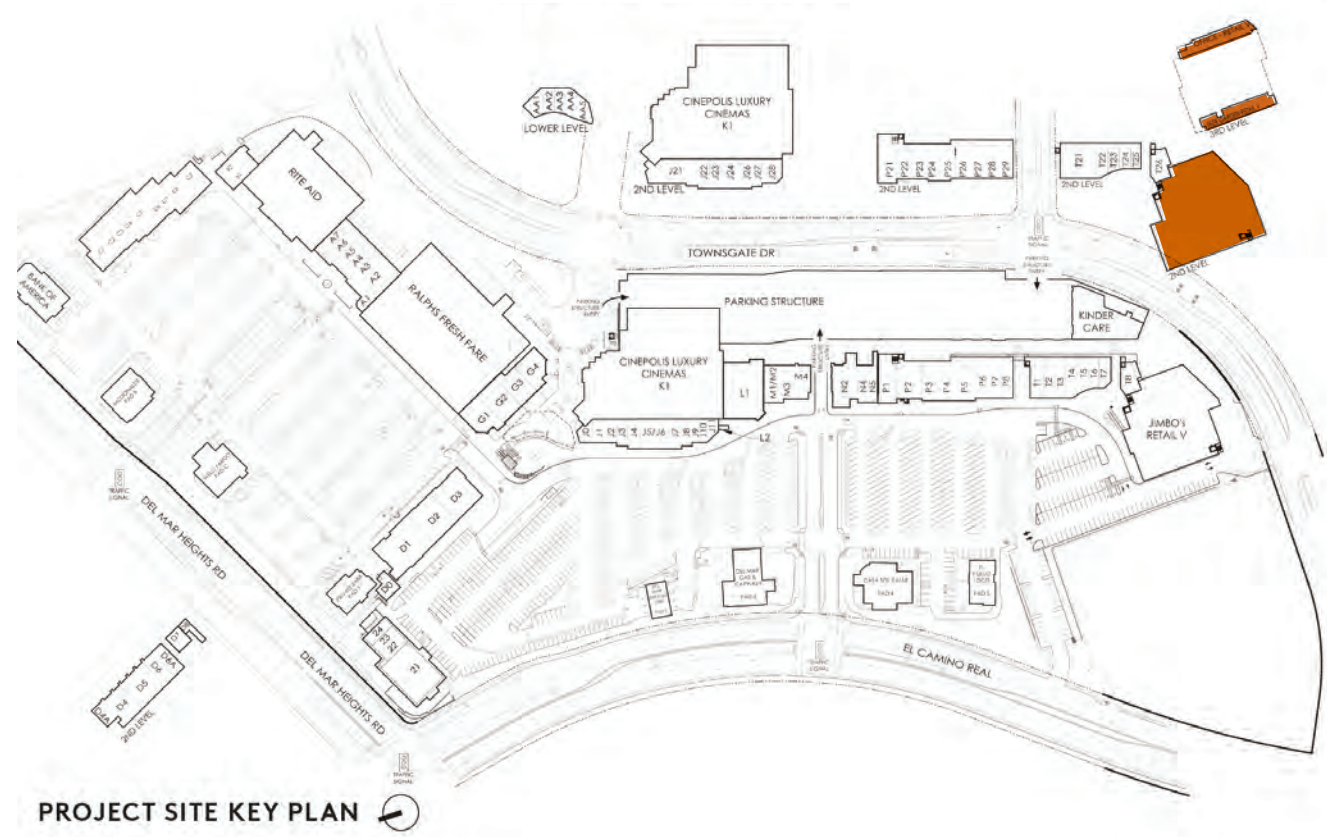

SCALE 1" = 25'
0 5 25