

Central Downtown Oceanside Retail Space on Coast Hwy

FOR LEASE



215 S. Coast Hwy., Oceanside, CA 92054 / 3,500 SF

PRIME

Oceanside Location

- Perfect opportunity to be in a central location in the heart of Downtown Oceanside
- Great natural light with sliding glass storefront doors
- Abundant onsite parking available
- Ideal open floor plan with high ceilings and roll up door in the rear
- Adjacent to Amtrak & Coaster transit center
- Excellent visibility on Oceanside's Coast Highway
- Walking distance to central Downtown Oceanside and residential coastal Oceanside
- Ideal coastal location, just 4 blocks from the beach
- Take advantage of the upcoming development in Oceanside's Nine Block Master Plan
- Join renowned restaurant & retail tenants such as LTH, Regal Cinemas, Dija Mara, Swami's Cafe, Barrel Republic & more



[LINK TO ADDITIONAL PHOTOS →](#)



Renowned Neighbors



DIJA MARA





BE A PART OF OCEANSIDE'S BOOMING DEVELOPMENT

215 S. COAST HWY., OCEANSIDE, CA 92054



Floor Plan



215 S. Coast Hwy., Oceanside CA 92054

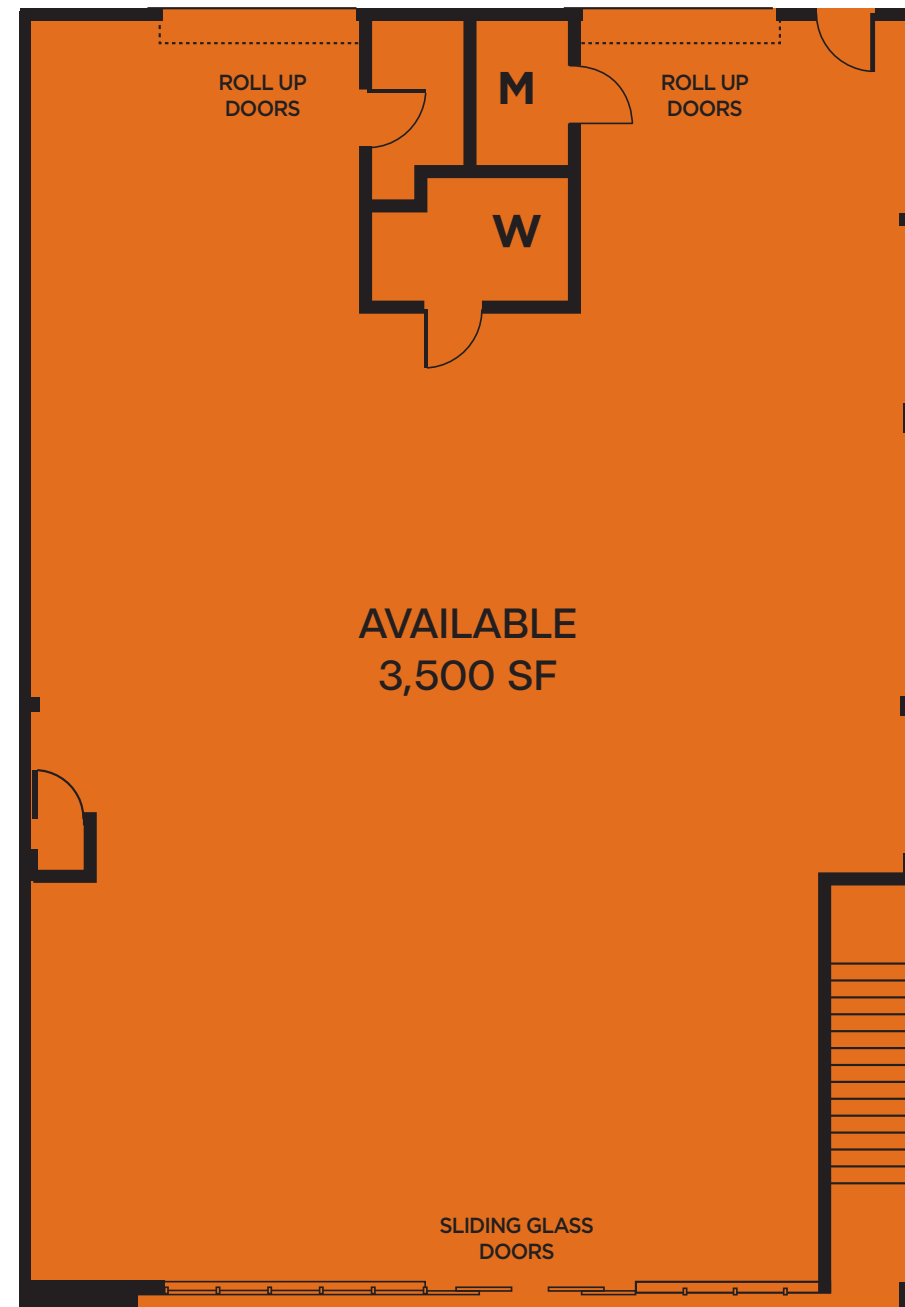

← S. Coast Hwy. →

01

CARTEBLANCHE
COCKTAILS

02

VINEYARDS
ORFILA
AND WINERY

03

SEÑOR GRUBBY'S

04

STONE
BREWING CO.

05



06



07

REGAL
CINEMAS

08

Breakwater
Brewing Co.

09



10

MASTERS
KITCHEN & COCKTAIL

11

DIJA MARA

12



13

Local Tap House
LTH
& Kitchen

14

ST
SAINT TROPEZ
Bistro and Beyond

15



16

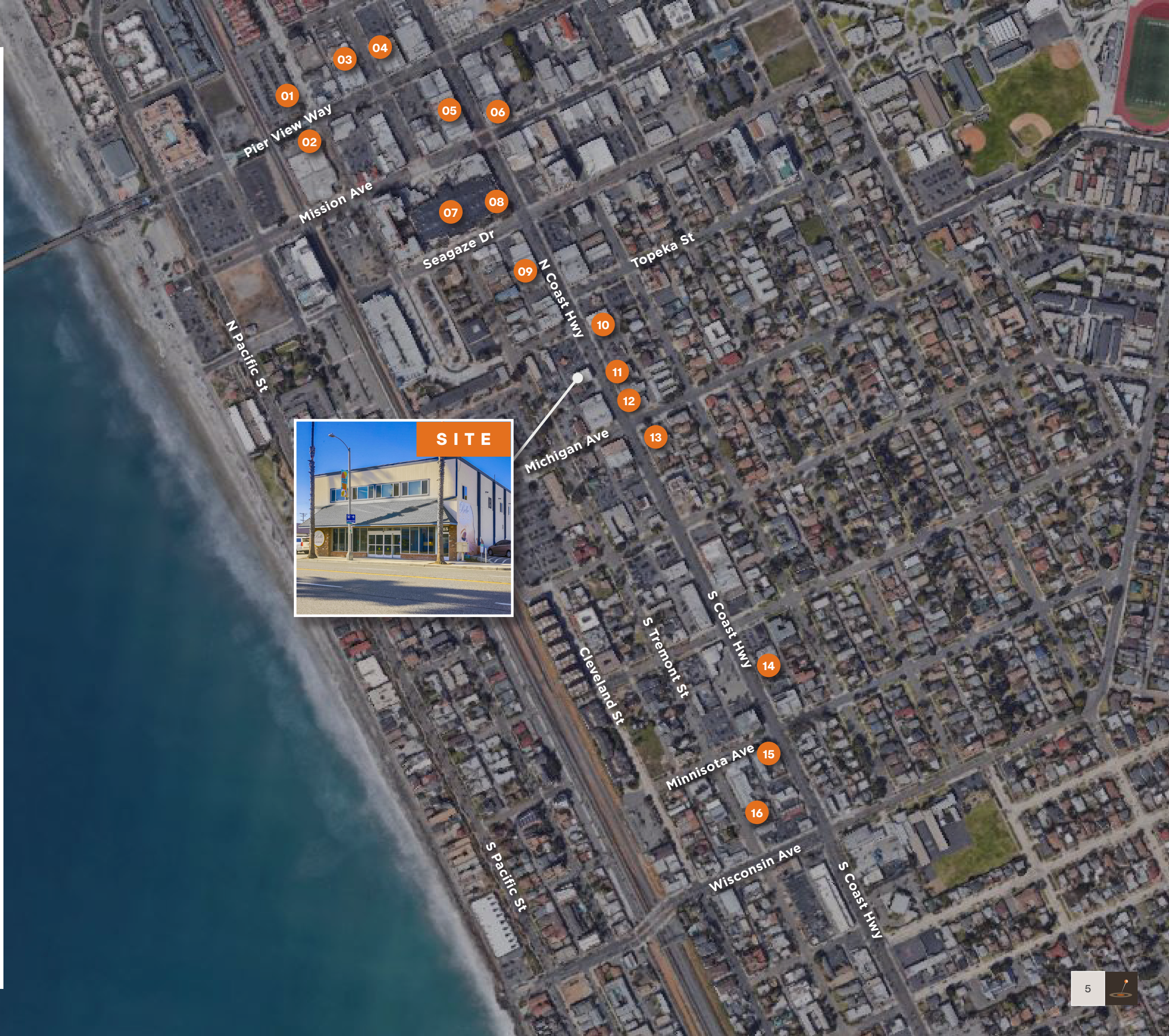

Goings On in Oceanside

OCEANSIDE HARBOR

A little bit of paradise. 950 pleasure boat slips, quaint village shopping at resort-style boutiques, top-name restaurants, cafes al fresco, congenial people, picnicking in mini-parks overlooking the harbor, and strolling or jogging around this idyllic setting.

SUNSET MARKET

This event has been a bright spot in downtown Oceanside since August 2007 and is so much more than a Farmers Market. Thousands of residents and visitors alike gather each week to enjoy the varied hot food offerings, the eclectic merchandise selections, the gourmet packaged food section and the live entertainment.



OCEANSIDE PIER

Oceanside represents the only City in the county to have a Pier, Harbor, and Ampitheatre. Stretching out at about 1954 feet, Oceanside's pier is the longest wooden over-water pier on the west coast of the United States. Walk the length of the pier for some truly awe-inspiring views of the downtown coastline.

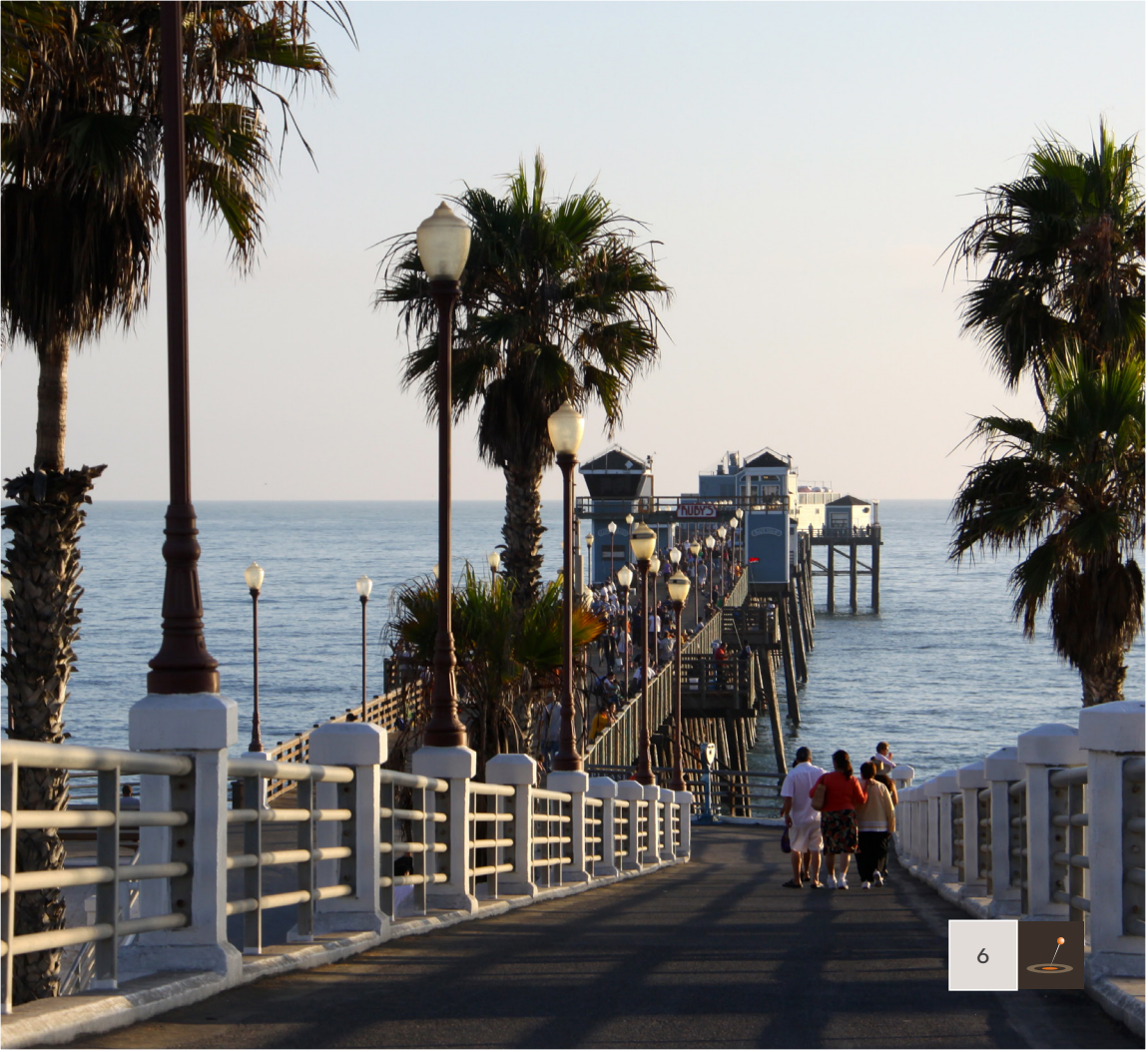

OCEANSIDE FARMER'S MARKET

Held every Thursday morning, this vibrant market offers a variety of fresh local produce and flowers, and a huge selection of gourmet goodies including artisan baked goods, organic honey, salsa and chips, dips and sauces, and so much more! Shop from among dozens of crafts booths for a selection of handmade goods including jewelry, wearing apparel, soap and lotions, seashells, photography and many others. Corner of Pier View Way and Coast Hwy.





Demographics

5 MINUTES

 Daytime Population	6,323
 Population	15,845
 Average HH Income	\$70,203

10 MINUTES

 Daytime Population	27,654
 Population	62,510
 Average HH Income	\$80,047

15 MINUTES

 Daytime Population	65,190
 Population	190,778
 Average HH Income	\$89,732

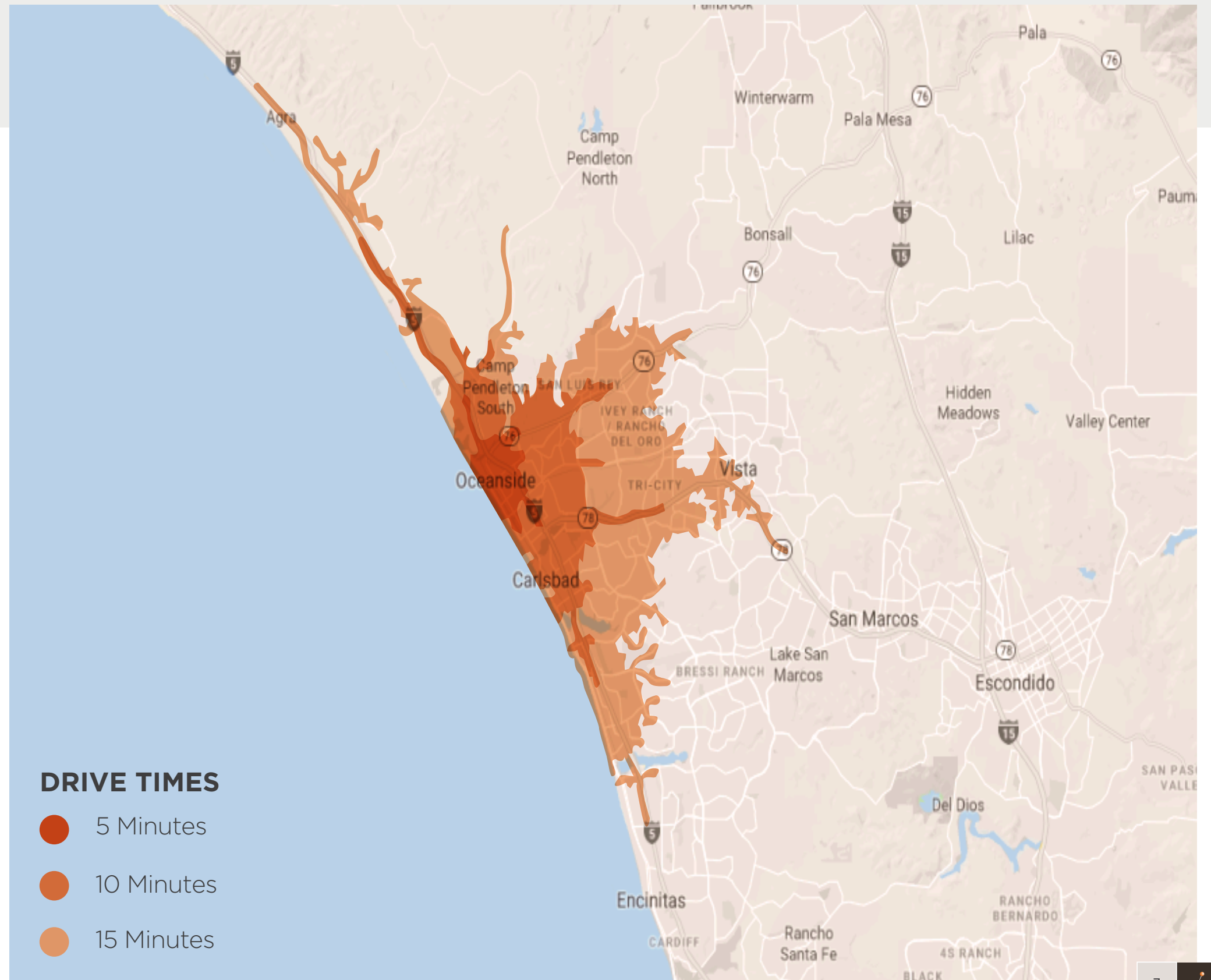



Leasing Inquiries



Marc Karren, Associate
marc@locationmatters.com
858-779-3196
CA LIC #01912607

FOR LEASE

215 S. Coast Hwy., Oceanside, CA 92054

locationmatters.com

